



# Architects & Designers Product Information



[caesarstone.co.za](http://caesarstone.co.za)

5810 Black Tempal

2024



<b>1. INTRODUCTION</b>	<b>4</b>
<b>2. PRICE CATEGORIES</b>	<b>5</b>
<b>3. SLAB INFORMATION</b>	<b>7</b>
3.1 Slab Data	7
3.2 Slab Identification Stamp	7
<b>4. PRE-FABRICATION</b>	<b>9</b>
4.1 Measuring by Dimension	9
4.2 Utilization of the Slab	10
<b>5. FABRICATION</b>	<b>11</b>
5.1 Cutouts	11
5.1.1 Methods of Fabricating Cutouts for Accessories	12
5.2 Fabricating Edges	13
5.2.1 Single Thickness Edges	13
5.2.2 Mitre Edges	14
5.2.3 Laminated Edges	16
<b>6. INSTALLATION</b>	<b>17</b>
6.1 Attaching Accessories with Adhesive	17
6.2 Overhangs	17
6.3 Flooring and Wall Cladding	18
6.4 Commercial Food Service Installations	19
<b>7. CARE &amp; MAINTENANCE</b>	<b>20</b>
7.1 Heat Resistance	20
7.2 Scratch Resistance	20
7.3 Stubborn Stains or Dried Spills	21
7.3.1 Recommended Stain Removers	21
7.4 Caesarstone Cleaning Products	21
<b>8. THE VISUALISER ONLINE DESIGN TOOL</b>	<b>22</b>
<b>9. ENVIRONMENTAL COMMITMENT</b>	<b>23</b>
<b>10. GREEN STAR COMPATIBILITY</b>	<b>25</b>
10.1 Green Star Environmental Impact Categories	25
10.2 Green Star Materials Calculators	25
10.2.1 Caesarstone products - Green Star Summary	26
10.2.2 Green Star Office Design and Office As Built v3 Tools	27
10.2.3 Green Star Office Interiors v1.1 Tool	27
10.2.4 Green Star Education v1 Tool	28
10.2.5 Green Star Healthcare PILOT Tool	29
10.2.6 Green Star Shopping Centre PILOT Tool	30
10.2.7 Green Star Multi Unit Residential PILOT Tool	30
<b>11. TECHNICAL DATA</b>	<b>31</b>
<b>12. OUTDOOR COLLECTION</b>	<b>33</b>
12.1 Introduction	33
12.2 Slab Data	33
12.2.1 Finishes	33
12.2.2 Dimensions and Weight	33
12.2.3 Slab Label	34
12.3 Fabrication Guidelines Specific to Caesarstone Outdoor	35
12.4 Installation Guideline Specific to Caesarstone Outdoor	36
12.4.1 General	36
12.4.2 Grill Installation Guidelines	36

<b>13. RESIDENTIAL LIFETIME WARRANTY</b>	<b>37</b>
<b>14. COMMERCIAL WARRANTY</b>	<b>38</b>
<b>15. OUTDOOR COLLECTION WARRANTY</b>	<b>39</b>
<b>CONTACT DETAILS</b>	<b>41</b>



## Quick assistance

### Expert technical advice

#### Caesarstone Technical Manager

Email: andrea@interslab.co.za

Cell: 083 777 1547

Our Caesarstone technical manager is an experienced stone mason who has been trained at the Caesarstone University, Israel and is available to give advice and assistance in technical matters related to Caesarstone.

### Large project pricing assistance

#### Caesarstone Projects Manager

Email: kerrylee@interslab.co.za

Cell: 082 654 1884

Our Caesarstone Projects Manager is experienced in working on larger projects and is able to give assistance in pricing for large projects and provide samples or marketing materials needed for presentations.



## 1. Introduction

Caesarstone quartz surfaces are ideal for a wide range of interior commercial and residential applications, including those subject to intense use. Common applications include: kitchen counter tops, bathrooms, bar tops, vanities, interior cladding, reception counters, flooring, wall cladding and furniture.

Caesarstone quartz surfaces are not suitable for exterior use, or on any areas that are exposed to UV radiation or excessive heat.

Caesarstone quartz surfaces are manufactured in a range of colours, divided into several collections with unique properties.

Caesarstone quartz surfaces are manufactured from up to 93% quartz (one of nature's hardest minerals) and high-quality polymer resins and pigments that are compacted under intense vibration, vacuum and pressure into dense, non-porous slabs. Caesarstone's quartz slabs are then post cured, gauged to various thicknesses and polished.

### Why is Caesarstone different?

- **Differentiated colour palette**
- **Materiality: adds value to property selling price**
- **Lifetime warranty for residential installations**
- **Excellent customer / technical service**
- **Completely non-porous, no sealing required**
- **Highly durable and extremely hard**
- **Extremely chip & crack resistant**
- **Heat and chemical resistant**
- **Impervious to stains**

4030 Oyster

\*Shade, movement and graining of actual product may vary from sample or image. We recommend that you select your preferred slabs at the distributor nearest you.

 **caesarstone**<sup>®</sup>  
it's different

## 2. Price categories

As passionate as we are about design, we are equally committed to providing the best quality and service. Caesarstone has received worldwide recognition for our commitment to quality, safety and environmental standards. No matter which price range our designs fall into, each and every one of our surfaces are carefully inspected to ensure it meets the highest level of international quality standards.

### STANDARD

Ideal for a variety of residential and commercial applications, this classic range of designs offer the same desirable assurance of Caesarstone, at an attractive entry-level price. Delight in your dream surface, because you don't need to break the bank to have the best quality. This timeless collection of consistent textures and designs offer our trusted strength, durability and Lifetime Warranty, so that everyone can enjoy the benefits of Caesarstone.

### MID RANGE

At a mid-range price you can enjoy an ultra-modern aesthetic without compromising on durability. These resilient surfaces make a genuine design statement with unparalleled performance and style. Combining the spirit of nature with the highest performance of Caesarstone, these designs take it up a notch in terms of complex and trending styles.

### PREMIUM

These designs aren't like any other you'll find on the market. Achieving the exquisite appearance of natural stone, they include a variety of intricate veins, bold colours and textures. Complexity and uniqueness are mirrored alongside superior quality, precision and unrivalled durability. These colours will enhance the design of any luxurious interior and make a real statement.

### OUTDOOR

For the first time in quartz history, an outdoor surface made to weather any storm. The Caesarstone Outdoor Collection is a breakthrough combination of high durability and UV resistance for outdoor luxury. The Collection has been designed to reflect the authentic patinas of industrial materials. The variations in appearance capture depth and movement, making each slab unique.

We'd love to hear from you. For any queries, visit our website [caesarstone.co.za](http://caesarstone.co.za) or call us on 083 608 5810.



#### PRICE CATEGORY: STANDARD

Code	Caesarstone Colours	Collection	Finish	13 mm	20 mm	30 mm
3141	Alaska	Classico	Polished	✓	✓	✓
6141	Ocean Foam	Classico	Polished		✓	
2141	Snow White	Classico	Polished		✓	✓

#### PRICE CATEGORY: MID RANGE

Code	Caesarstone Colours	Collection	Finish	13 mm	20 mm	30 mm
6131	Bianco Drift	Supernatural	Polished		✓	
4130	Clamshell	Classico	Polished		✓	
6003	Coastal Grey	Supernatural	Polished		✓	
7110	Burnt Cordite	Classico	Polished		✓	
4030	Oyster	Classico	Polished		✓	
4120	Raven	Classico	Polished		✓	
4004	Raw Concrete	Metropolitan	Concrete		✓	
4230	Shitake	Classico	Polished		✓	
4003	Sleek Concrete	Metropolitan	Concrete	✓	✓	

#### PRICE CATEGORY: PREMIUM

Code	Caesarstone Colours	Collection	Finish	13 mm	20 mm	30 mm
4044	Airy Concrete	Metropolitan	Concrete		✓	
5810	Black Tempal	Metropolitan	Concrete		✓	
4011	Cloudburst Concrete	Metropolitan	Concrete		✓	
5820	Darcrest	Supernatural	Honed		✓	
5151	Empira White	Supernatural	Polished		✓	
4046	Excava	Metropolitan	Concrete		✓	
5141	Frosty Carrina	Supernatural	Polished		✓	
6046	Moorland Fog	Supernatural	Polished		✓	
4043	Primordia	Metropolitan	Concrete		✓	
1001	Riverlet	Classico	Honed		✓	
4033	Rugged Concrete	Metropolitan	Concrete		✓	
5031	Statuario Maximus	Supernatural	Polished	✓		
5100	Vanilla Noir	Supernatural	Polished		✓	
5143	White Attica	Supernatural	Polished	✓		

#### COLLECTION: OUTDOOR

Code	Caesarstone Colours	Collection	Finish	13 mm	20 mm	30 mm
406	Clearskies	Outdoor	Concrete		✓	
405	Midday	Outdoor	Concrete		✓	
515	Palm Shade	Outdoor	Honed		✓	



### 3. Slab Information

#### 3.1 Slab Data

Slab data provided here are nominal only, for storage and transportation purposes. Actual usable slab surface is slightly less per side due to the bevelled perimeter.

- ◆ **Sizes include:**  
3,040 m x 1,440 m  
3,230 m x 1,630 m  
3,330 m x 1,630 m
- ◆ **Thickness per slab**  
13 mm ; 20 mm ; 30 mm
- ◆ **Weight per slab**  
140 kg ; 220 kg ; 330 kg

**Please note: Not all colours are available in all sizes and thicknesses. Please consult your supplier to find out more information. 13 mm slabs are available in selected Ultimo colours only.**

#### 3.2 Slab Identification Stamp

A stamp appears on the back of the slab with identification information. This information remains on the slab for its lifetime and can be used for identification after installation.

##### Detail of Identification Stamp on Back of Slab:

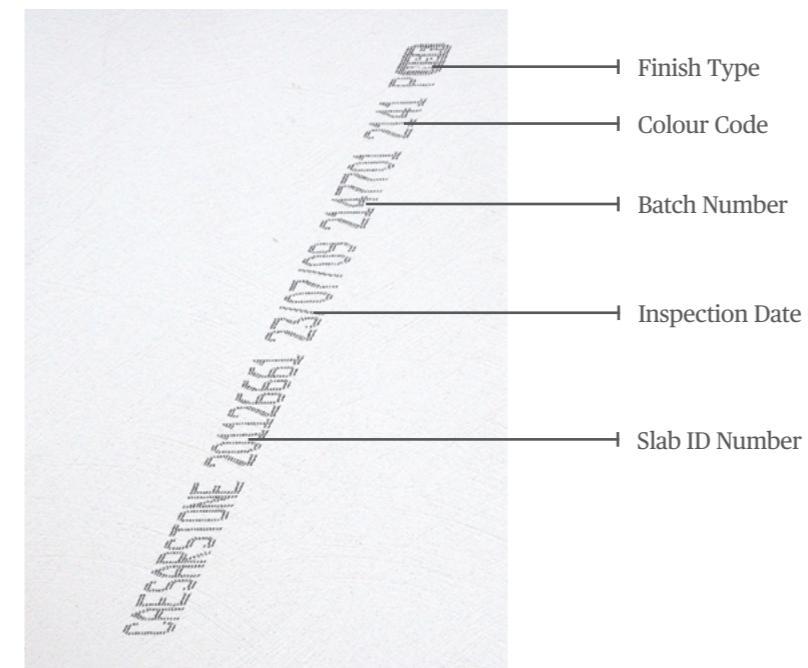

Cloudburst Concrete 4011  
\*Shade, movement and graining of actual product may vary from sample or image. We recommend that you select your preferred slabs at the distributor nearest you.

## 4. Pre-Fabrication

### 4.1 Measuring by Dimension

Create a clear diagram on which to record the measurements, preferably on a computer or professional drawing board with a ruler.

Use the front line of the installation as the central line of the diagram from which to draw all other measurements. If the front line is not perfectly straight, create a straight line on the cabinet to use as the central line.

- Mark on the diagram the center point of items to be installed in the countertop, such as sinks and stove tops.
- Check that the sum of the dimensions that make up one side are equal to the length of the whole side.
- Do not assume that corners are exact 90° angles... measure the sides or use an angle measure.
- A deviation of 1° in a 90° angle creates a deviation of 52 mm (2") per 3 m (9' 9")

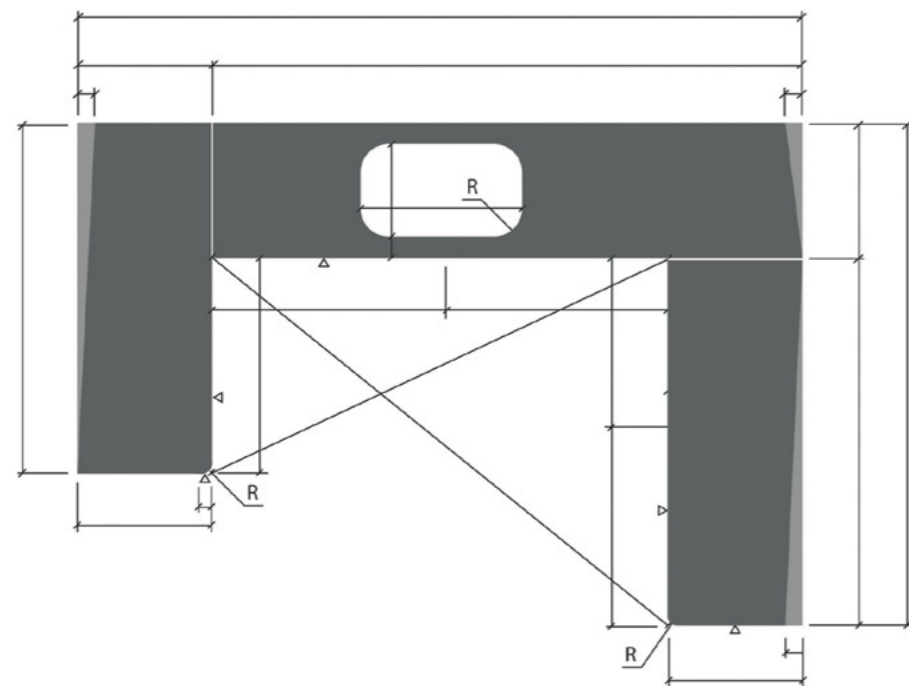

◆ **Note:** Measuring can also be performed via laser, which is automatically converted by a computer program to a work plan.

### 4.2 Utilization of the Slab

- Plan the arrangement of the pieces to be cut from the slab to minimize wastage.
- Take into account that a minimal amount must be cut off the outer perimeter of the slab in order to straighten the edges.
- Check the flatness of the surface at the locations planned for seams.
- Do not cut seams or visible edges of the countertop from the edges of the slab.
- Use the edges of the slab for the part of the countertop adjoining the wall

**Example of arrangement of cut slab pieces with lamination strips:**

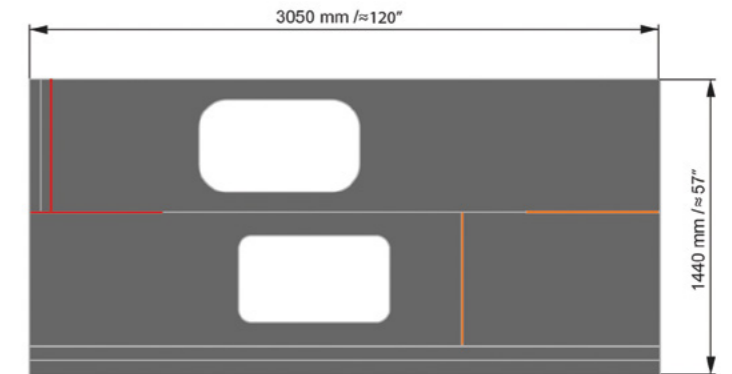

**Example of plan of slab pieces:**

- ◆ **Note:** It is possible to create approx. 7.2m of countertop from one slab (at 600mm width). As the slab width is 1,44m wide, the most economical use of the slab suggests that the island and counter be cut to the following widths:
- 600mm countertop
  - 800mm island



**Example of template arrangement before cutting the slab:**

## 5. Fabrication

### 5.1 Cutouts

- Fabricate cutouts according to the instructions of the manufacturer of the item to be installed.
- Fabricate a minimum radius of 15 mm (9/16") for all corners in cutouts; see figure 1. The larger the radius, the stronger the corner.

In the event that fabricating a 15 mm (9/16") cutout corner radius would prevent the proper installation of an item that requires a 90° angle corner, drill beyond the corner with a cup drill; see figure 3.

⚠ **Important:** Take care not to cut beyond the rounded edge in cutouts; see figures 2 and 4.

⚠ **Important:** Damage to the area may lead to the formation of hairline cracks.

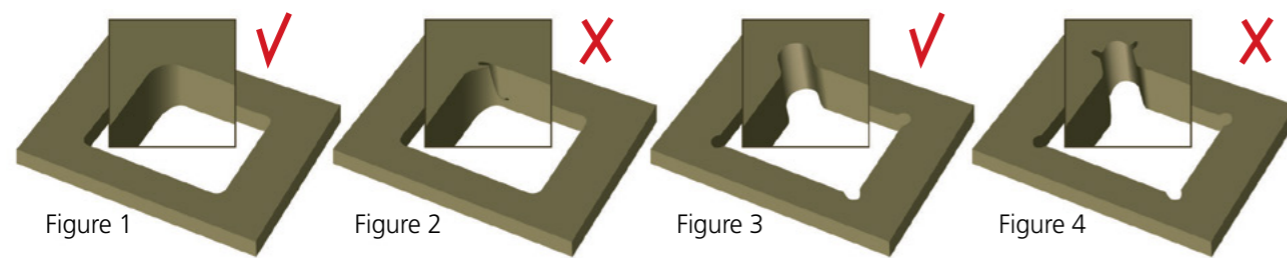

⚠ Do not reduce the thickness of the surface when preparing the cutout.

⚠ The distance between a cutout and an edge or seam must be no less than 60 mm (2 1/2"). The greater the distance, the stronger the area.

⚠ If the distance between a cutout and an edge or seam is less than 150 mm (6"), the area must be supported: Ensure that the area between the cutout and the edge or seam is located over the junction between the base cabinets; or fit a solid support strip under the area.

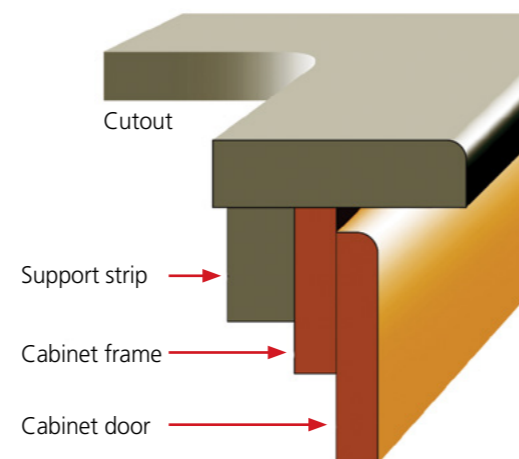

### 5.1.1 Methods of Fabricating Cutouts for Accessories

It is generally necessary to install accessories, such as sinks and stovetops, in countertops. There are three main methods of installing accessories in cutouts, each of which requires a different type of cutout fabrication:

#### Under-mount Installation

- In under-mount installation, the accessory is positioned underneath the surface.
- Fabricate the cutout slightly smaller than the accessory so that the joint between the accessory and the surface is not visible. Round or bevel the edge. Polish the edges of the cutout.

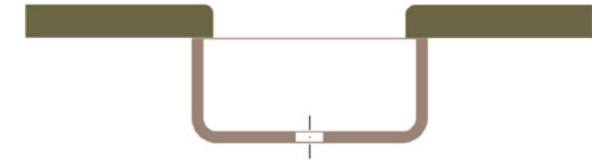

#### Over-mount Installation

- In over-mount installation, the lip of the accessory extends above the surface and rests on it.
- Smooth the edge of the cutout with a grinding wheel and leave it unpolished. Leave a space between the accessory wall and the surface.

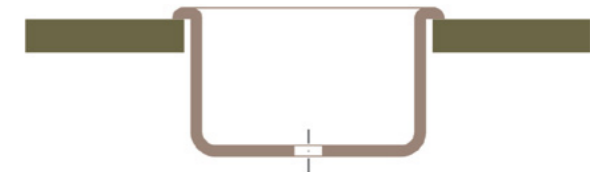

#### Flush Installation

- In flush installation, the accessory is installed almost or completely flush with the surface by a method resembling fitting a cone into a cone. The lip of the accessory is slightly wider at its top edge than at its bottom edge.
- Fabricate the cutout in the surface on a slight angle to create a cone shape, so that the top of the cutout is wider than the bottom of the cutout. The accessory can then be slotted into the cutout. The size of the cutout determines the position of the accessory relative to the surface.

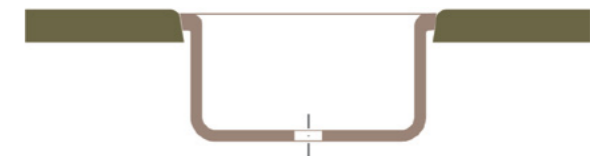

⚠ **Important:** Caesarstone recommends installing accessories slightly lower than the surface and rounding the exposed edge to prevent the accessory protruding above the surface.

⚠ **Important:** Do not attach the accessory to the surface by polishing or reducing the surface to meet the accessory.

## 5. Fabrication continued

### 5.2 Fabricating Edges

- All exposed edges must be fabricated to the same finish as the surface.
- The top and bottom of edges must be rounded or beveled. Do not create square edges.
- All edges must have a minimum edge profile of 3 mm (1/8”).

◆ **Note:** The most common edge details are radius or 45° bevel; however, there is a very wide range of detail options.

◆ **Note:** The larger the surface area of the edge, the more resistant it is to chipping.

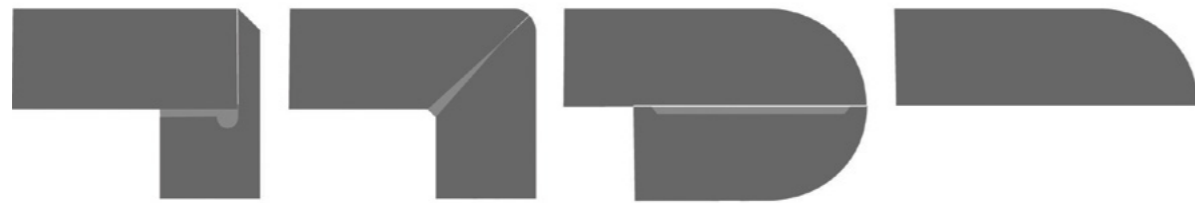

#### 5.2.1 Single Thickness Edges

- Single thickness edges are the original thickness of the slab.
- Single thickness edges are easily and quickly fabricated.
- Most automated edge profiling machinery is designed to create single thickness edges.

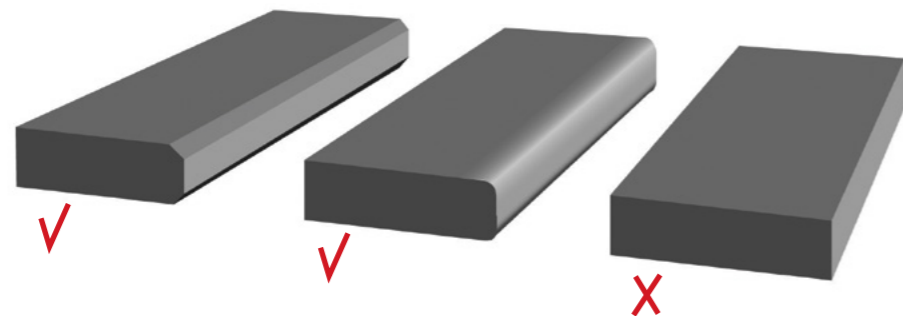

#### 5.2.2 Mitre Edges (recommended)

##### Characteristics of Mitre Edges

- Mitre edges allow the fabrication of edges of any height. The height of the edge is independent of the thickness of the slab.
- Mitre edges enable the continuation of a pattern around an edge.
- Mitre edges can be used to create edge profiles of various shapes and depths.
- Polishing the vertical part of the mitre is not required as the visible area is the polished surface of the slab.



## 5. Fabrication continued

### Fabrication of Mitre Edges

- Cut a strip from the slab. The width of the strip must be the same as the height required for the mitre edge.
- For mitre edges on the Concetto colours, cut the slab at the location planned for the mitre joint to create continuation of the slab pattern.
- Fabricate mitre edges at a 45° angle to ensure maximum strength and enable a final edge angle of 90°. An angle of less than 45° makes the edge prone to chipping.
- After cutting the 45° angle, reduce the angle slightly on the back part of the mitre with a manual tool to create space for the adhesive. This allows for a strong joint and flush closure on the visible part of the mitre.

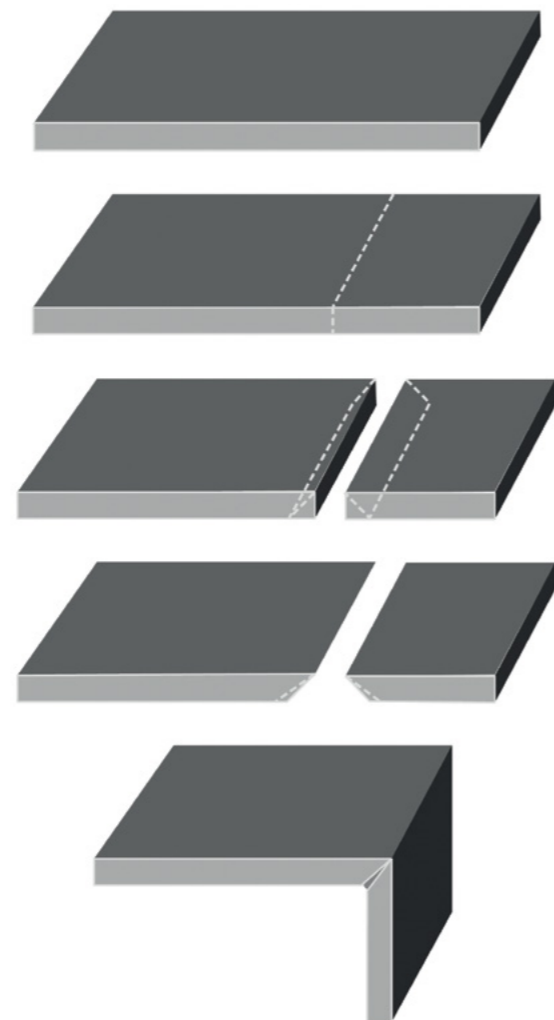

◆ **Note:** Polish the mitre joint to a radius or bevel profile as required.

- A joint in the middle of a small radius or bevel makes the edge prone to chipping. It is therefore recommended to create a large radius.

◆ **Note:** Distribute the adhesive evenly throughout the joint for maximum strength.

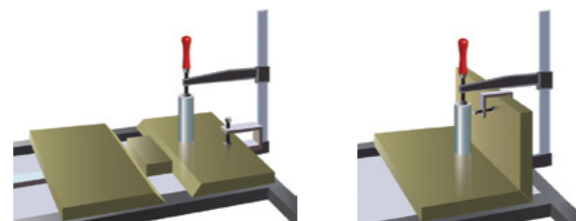
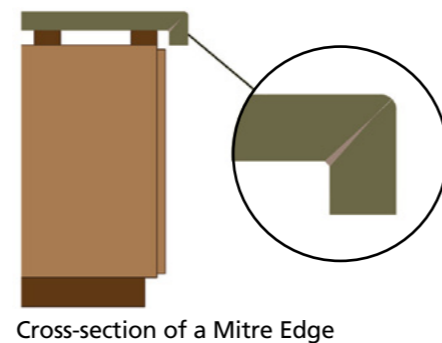

### 5.2.3 Laminated Edges

Lamination is the process of gluing one or more strips of Caesarstone surfaces along the bottom edge of another piece of Caesarstone surfaces in order to create the illusion of a thicker slab. This process is more complex and time consuming than fabricating single thickness edges. The mitred edge option is the preferred one.

- Cut lamination strips from the same slab as the countertop, and wherever possible from the same saw cut, to ensure a colour match.
- The lamination strip should be the same length as the piece of surface to which it is attached. Joints in lamination strips will, therefore, be aligned with the surface seams. If, however, it is necessary to create the lamination strip out of more than one piece, make a 45° angle diagonal joint; see figure below right.
- Cut lamination pieces on outside corners at a 45° angle.
- If the lamination strip hinders the opening of the cabinet doors, raise the surface by the use of elevation/support strips along the whole length of the front and back of the cabinet. The strips must be 70 mm (23/4") wide, and the same height as the part of the lamination strip that protrudes underneath the slab; see below left.
- The preferred method of laminating edges is the mitre cut; see section 8.2.2.

◆ **Note:** It is recommended to fabricate the elevation strips out of Caesarstone surfaces.

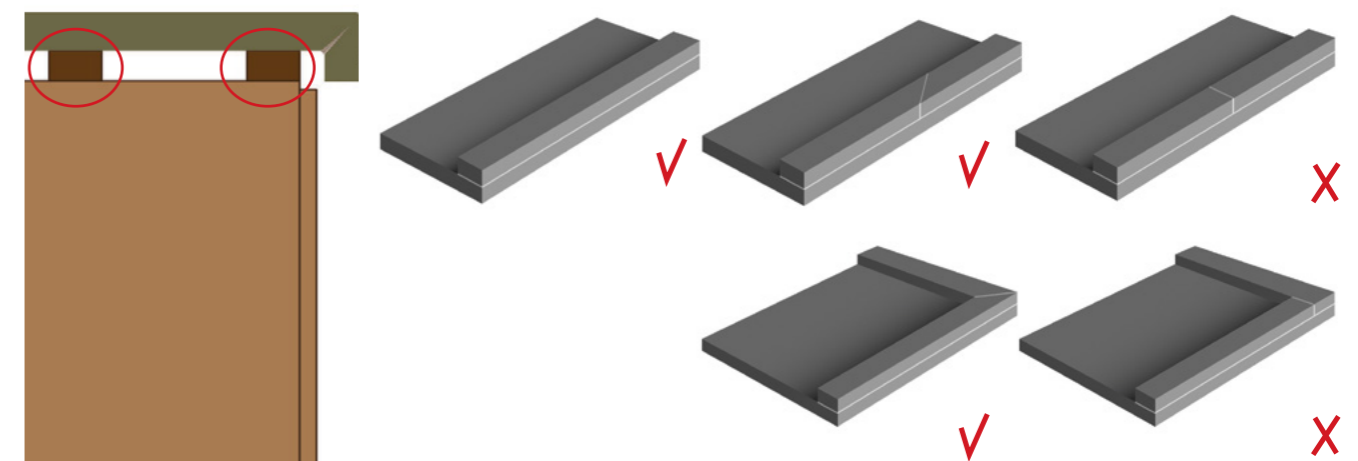

## 6. Installation

### 6.1 Attaching Accessories with Adhesive

- Most accessories are supplied with an integral self-adhesive pad, which can be attached directly to the surface.
- If the accessory is not supplied with a self-adhesive pad, attach the accessory to the surface with an appropriate adhesive, e.g., neutral 100% silicone.

◆ **Note:** The larger the area of adhesion, the stronger the bonding.

### 6.2 Overhangs

An overhang is a surface that is not directly supported by a construction underneath, e.g., a surface that extends past the edge of the supporting cabinet for use as a countertop.

- Extra strength can be provided by laminating the edge of the overhang and attaching another slab of the same thickness underneath. In this case, the bottom slab is attached back to back underneath the surface so that the polished surface is exposed underneath the slab.
- The permitted overhang dimension must be determined by a professional. It is dependent on a number of factors, such as:

- The complete length to width ratio of the surface relative to the length and width ratio of the overhang.
- Whether the overhang is supported on one or more sides by a wall or other supporting fixture.

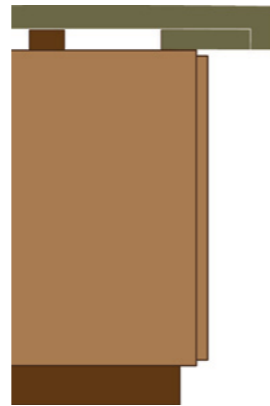

◆ **Note:** Overhanging surfaces of 13 mm require more support than those of 20 or 30 mm. Reinforce 13 mm overhangs with strips of Caesarstone material or a metal frame.

The table below provides approximate guidelines for support required for overhangs:

20 mm thickness slabs	30 mm thickness slabs	Support required
<300 mm (12")	<400 mm (16")	No additional support required
300-500 mm (12-20")	400-600 mm (16-24")	Support brackets at 600 mm (24") intervals
>500 mm (20")	>600 mm (24")	Legs, columns or panels

### 6.3 Flooring and Wall Cladding

Caesarstone slabs are suitable for use as flooring, wall cladding, countertops, stairs, elevator cladding, bathrooms, whirlpools, spas and many other applications. Caesarstone material is intended for interior use only. Installation of Caesarstone material must be carried out according to relevant local standards and safety regulations. It is recommended that installation be performed by a skilled, experienced installer. The installer, in consultation with the construction engineer, must ascertain that the physical properties (friction coefficient, thermal expansion, etc.) of the particular type and finish of Caesarstone material selected for installation are suitable for the specific environment. Caesarstone material must be cut with water-cooled diamond cutting tools. Anti-slip treatment may be applied to Caesarstone flooring if considered advisable by the construction engineer or if required by local regulations.

Caesarstone does not provide warranty for flooring or wall cladding applications. Caesarstone is responsible only for proven manufacturing defects in the products. Contact your local distributor for the Caesarstone warranty policy. Dedicated brochures with specific product recommendations by Laticrete, Mapei and Ardex for the installation of Caesarstone material are available from Caesarstone. Most accessories are supplied with an integral self-adhesive pad, which can be attached directly to the surface. If the accessory is not supplied with a self-adhesive pad, attach the accessory to the surface with an appropriate adhesive, e.g., neutral 100% silicone.

◆ **Note:** The larger the area of adhesion, the stronger the bonding.



## 6. Installation continued

### 6.4 Commercial Food Service Installations

Caesarstone® material can be used in a variety of commercial food service installations, including those that incorporate heating and cooling equipment.

Caesarstone does not design, fabricate or install the finished surfaces. This should be carried out by experienced professionals who are familiar with the physical properties of Caesarstone material.

Caesarstone does not provide warranty for commercial food service applications. Caesarstone is responsible only for proven manufacturing defects in the product. Consult your local distributor for the Caesarstone warranty policy.

### General Requirements

- Provide adequate structural support for both the Caesarstone material and any other external loads. Do not use Caesarstone material as structural support. External loads must be compressive loads only. Compressive loads must never exceed the limits provided in the Caesarstone technical data.
- Do not use the Caesarstone material to transfer any bending and/or shear loads from external equipment to supporting structures. See diagrams on p. 7.
- Design the installation to minimize thermal and mechanical stress and allow for expansion and contraction of the Caesarstone material.
- Use only 30 mm thickness Caesarstone material for food service installations.
- Provide adequate distance between the Caesarstone material and any adjacent walls, cabinets or other constraint.
- Provide a minimum of 3 mm (1/8") clearance between the surface and any columns or brackets that penetrate the material.
- Provide space for insulating materials and extra equipment support. Always isolate the weight of a drop-in food well with additional supports.
- Due to high traffic and abuse, Caesarstone recommends that edge details have a minimum of 5 mm (3/16") radius on both top and bottom, and a minimum of 6 mm (1/4") on outside corners. This applies to fixed installations and movable tables.

 **Note:** For underlayments, use only moisture-resistant support materials.

## 7. Care and Maintenance

### Tough, Yes – Indestructible, No.

Caesarstone recommends using water and a mild detergent or a high-quality spray and wipe-type cleaner on a soft cloth or non-abrasive sponge for routine cleaning of Caesarstone surfaces. Consult with your distributor for specific products recommended in your local market.

In general, it is recommended to use cleaning products between pH 5-9, as products outside this range may damage the surface. It is recommended to leave cleaning products on the surface for no more than 5 minutes.

 **Important:** If it is necessary to leave cleaning products on the surface for more than 5 minutes, check their effect in advance on a separate piece of the surface.

- Do not use products that contain trichlorethane or methylene chloride, such as paint removers or strippers.
- If the surface is exposed to any potentially damaging products, rinse immediately with water to neutralize the effect.
- Do not allow dirt and residue to remain on Caesarstone surfaces for extended periods.
- Products containing oils or powders may leave a residue and should be rinsed off thoroughly.
- Thoroughly rinse cleaning materials off Caesarstone surfaces after use.

### 7.1 Heat Resistance

Caesarstone surfaces can tolerate moderately hot temperatures for brief periods of time. Prolonged exposure will result in discolouring or other types of damage. Excessive localized heat may damage the surface or cause hairline cracks.

 **Important:** Do not expose Caesarstone surfaces to temperatures higher than 100°C (212°F).

 **Important:** If the surface is exposed to temperatures higher than 70°C (158°F), support the surface from underneath to prevent warping.

 **Important:** Do not allow direct contact between Caesarstone surfaces and very hot pots or other hot cookware. Always use an insulator/trivet.

### 7.2 Scratch Resistance

Caesarstone surfaces are highly scratch resistant; however, avoid using sharp objects such as sharp knives or screwdrivers directly on the surface.

## 7. Care and Maintenance continued

### 7.3 Stubborn Stains or Dried Spills

Caesarstone surfaces are highly stain resistant. If a stain occurs it can usually be easily removed.

- Before treating the stains as described below, try to remove the stain with a damp, soft cloth with water and soap, or a non-abrasive household cleaner.
- For stains with adhered material, such as food, gum, nail polish or dried paint, first scrape away the material with a sharp scraper and then follow the instructions below.

#### 7.3.1 Recommended Stain Removers

Consult with your local distributor for products equivalent to those recommended below.

##### Organic stains

- Caesarstone spray cleaner. Available from any International Slab Sales branch.
- Caesarstone cream cleanser for tougher stains
- Windowlène® to restore the sheen

##### Chemical stains

- Mild, alcohol-based degreasers, such as Windex®
- Alcohol
- Interflon® Fin Degreaser EM30+

### 7.4 Caesarstone Cleaning Products

Caesarstone has developed a range of cleaning products specially designed and formulated to keep your quartz surfaces looking their best. Our cleaning products are available to purchase from all ISS branches. You can also buy them from our online store at [caesarstone.co.za](http://caesarstone.co.za).



## 8. The Visualiser Online Design Tool

The Visualiser lets you dream big with the security of seeing it all before you seal the deal. Pick the total look of your kitchen, bathroom or commercial space with ease after you've visualised your dream interiors. Then press a button and email it to your inbox. It's easy!

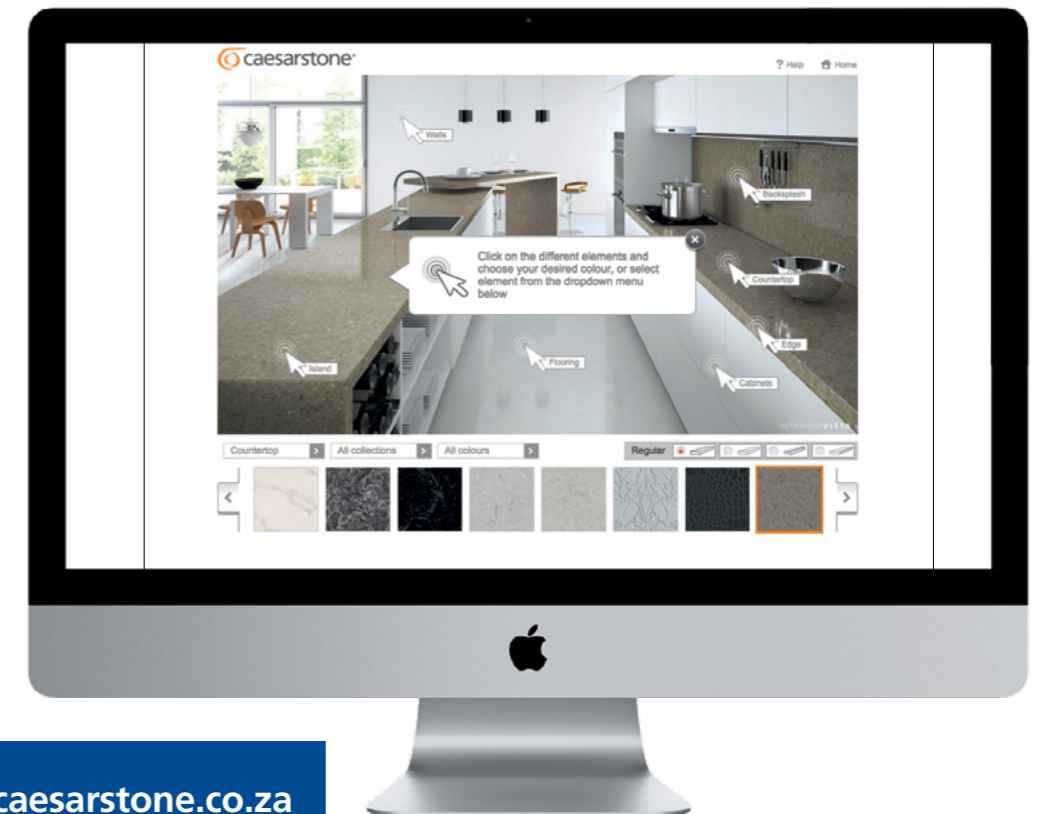







Available at [caesarstone.co.za](http://caesarstone.co.za)

## 9. Environmental Commitment

At Caesarstone, protecting the environment is a top priority. This means that everything we do – in our plant and outside – is governed by an environmental management policy. It begins with safety standards that protect all workers, and continues with ecologically friendly production processes.

As for our customers, they benefit from manufacture that assures totally inert products that prevent the spread of toxins and require almost no detergents. We at Caesarstone are working for a cleaner, safer and better quality environment. Everyone at Caesarstone is part of this commitment – it's our way of life.

 <p>GREEN BUILDING COUNCIL MEMBER ORGANISATION</p>	<p>Caesarstone is a member of the GBCSA. As a member of the World Green Building Council the GBCSA aims to promote and facilitate green building practices through market-based solutions, like the Green Star SA Environmental Rating System for Buildings. The Green Building Council of South Africa rating tools based on the Australian Green Building Council rating tools, provide the property industry with an objective measurement of Green Building.</p>
	<p>Caesarstone products are compliant with the National Sanitation Foundation International standard, ensuring that our working surfaces are safe for use in all food environments.</p>
 <p>as seen on <a href="http://ecospecifier.co.za">ecospecifier.co.za</a></p>	<p>Caesarstone quartz surfaces have been assessed and have met the criteria for inclusion in the ecospecifier list of environmentally friendly building materials. Pre-assessment has been conducted on Caesarstone materials and the finding is that they are likely to contribute to the achievement of Green Building credits.</p>
	<p>Caesarstone quartz surfaces comply with ISO 14001, ISO 9001, OHSAS 18001 and is a registered member of the USGBC (United States Green Building Council).</p>
	<p>Caesarstone surfaces comply with the American GEI (GREENGUARD Environmental Institute) certification, which primarily verifies that Caesarstone's products meet the most stringent air emission standards.</p>
	<p>Developed by USGBC, LEED (Leadership in Energy and Environmental Design) is an American accredited certification program for design, construction and operation of high performance green buildings. Caesarstone's LEED certification is another example of our compliance with ecological standards.</p>



4003 Sleek Concrete (counter, cladding, sink)  
\*Shade, movement and graining of actual product may vary from sample or image. We recommend that you select your preferred slabs at the distributor nearest you.

## 10. Green Star Compatibility

### 10.1 Green Star Environmental Impact Categories

Created by the Green Building Council of Australia, the Green Star rating system is designed to evaluate the environmental design and performance of buildings, and to drive the adoption of green building practices through market-based solutions.

All Green Star rating tools operate under the same framework of nine Environmental Impact Categories:

- Management
- Indoor Environment Quality
- Energy
- Transport
- Water
- Materials
- Land Use & Ecology
- Emissions
- Innovation

Each category is divided into specific credits that aim to improve the environmental performance of the building. Points are awarded for each credit for actions that demonstrate that the project has met the overall objectives of Green Star.

Caesarstone products address specific credits in the following impact categories:

- **Indoor Environment Quality**
- **Materials**

### 10.2 Green Star Materials Calculators

For Green Star Materials Calculators, Compliance of Caesarstone Mosaici Collection is as follows:

- **Environmental Management Systems:** Caesarstone has a comprehensive environmental management system, addressing all EMS criteria and ISO 14001 certification for its Stone manufacturing plant. To achieve points for EMS, the stone fabricator making the floor tiles must also meet the EMS criteria.
- **Product Stewardship, Modularity and Design for Disassembly:** The achievement of any additional points for these criteria is reliant on the design solution provided by the producer of the relevant product (i.e. flooring, tables, loose furniture, joinery).

10.2.1 Caesarstone products may contribute to the credit points for the Green Star Rating Tools summarized in this table:			Quartz Slabs	Concetto
<b>Green Star Office Design v3</b>				
Indoor Environment Quality	Volatile Organic Compounds	IEQ-13	✓	✓
<b>Green Star Office Interiors v1</b>				
Indoor Environment Quality	Volatile Organic Compounds	IEQ-11	✓	✓
Materials	Flooring	Mat - 2		
	Tables	Mat - 5		
	Joinery	Mat - 7		
<b>Green Star Education Pilot</b>				
Indoor Environment Quality	Volatile Organic Compounds	IEQ-12	✓	✓
Materials	Flooring	Mat-8		
	Loose Furniture	Mat-10		
	Recycled-Content & Reused Products and Materials	Mat-11		
<b>Green Star Healthcare Pilot</b>				
Indoor Environment Quality	Volatile Organic Compounds	IEQ-13	✓	✓
Materials	Recycled-Content Products & Materials	Mat-4		
	Flooring	Mat-9		
	Joinery	Mat-11		
	Loose Furniture	Mat-12		
<b>Green Star Shopping Centre Design Pilot</b>				
Indoor Environment Quality	Volatile Organic Compounds	IEQ-8	✓	✓
Materials	Recycled-Content Products & Materials	Mat-9	✓	✓
<b>Green Star Multi Unit Residential Pilot</b>				
Indoor Environment Quality	Volatile Organic Compounds	IEQ-7	✓	✓
Materials	Recycled-Content & Reused Products and Materials	Mat-7		
	Floor Coverings	Mat-9		

## 10. Green Star Compatibility continued

10.2.2 Green Star Office Design and Office As Built v3 Tools					
Environmental Impact Category	Credit Title	Credit No	Available Credits	Credit Compliance Criteria	Caesarstone Compliance
Indoor Environment Quality	Volatile Organic Compounds	IEQ-13	3	If 100% of the flooring surface used is any Caesarstone engineered stone, these materials will contribute up to 1 credit point.	Caesarstone stone surfaces have been certified to the Greenguard Children & Schools standard as low emitting products and confirm compliance to Green Star VOC levels of: <b>Total VOC limit:</b> 0.5mg/m2 per hour <b>4-PC:</b> 0.05mg/m2 per hour

10.2.3 Green Star Office Interiors v1.1 Tool					
Environmental Impact Category	Credit Title	Credit No	Available Credits	Credit Compliance Criteria	Caesarstone Compliance
Indoor Environment Quality	Volatile Organic Compounds	IEQ-11	8	If 100% of the flooring surface used is any Caesarstone engineered stone, these materials will contribute towards the achievement of up to 2 credit points. Where Caesarstone is used for as countertops and table tops for office fitout items, these materials will contribute towards the achievement of up to 2 credit points.	Caesarstone stone surfaces have been certified to the Greenguard Children & Schools standard as low emitting products and confirm compliance to Green Star VOC levels of: <b>Total VOC limit:</b> 0.5mg/m2 per hour <b>4-PC:</b> 0.05mg/m2 per hour
Materials	Flooring	MAT-2	5	If 100% of the flooring surface used is Caesarstone Mosaici range, these materials will contribute up to 1 point (or 27% of the product score) under the following criteria in the materials Calculator: <b>Eco preferred Content</b> <b>Durability</b> <b>Environmental Management Systems</b>	Caesarstone declares that the post consumer recycled content of the Mosaici range (7150 & 7250) is a minimum of 30% by mass. Caesarstone has a published 10 year limited warranty for all its products. Caesarstone has a current ISO 14001 certificate for its manufacturing plant in Israel.
Materials	Tables	MAT-5	1	If 100% of the table surface used is Caesarstone Mosaici range, these materials will contribute up to 40% of 1 point under the following criteria in the materials Calculator: <b>Eco preferred Content</b> <b>Durability</b> <b>Environmental Management Systems</b>	Caesarstone declares that the post consumer recycled content of the Mosaici range (7150 & 7250) is a minimum of 30% by mass. Caesarstone has a published 10 year limited warranty for all its products. Caesarstone has a current ISO 14001 certificate for its manufacturing plant in Israel.
Materials	Joinery	MAT-7	1	If 100% of the countertops used is Caesarstone Mosaici range, these materials will contribute up to 33% of 1 point under the following criteria in the materials Calculator: <b>Eco preferred Content</b>	Caesarstone declares that the post consumer recycled content of the Mosaici range (7150 & 7250) is a minimum of 30% by mass.

10.2.4 Green Star Education v1 Tool					
Environmental Impact Category	Credit Title	Credit No	Available Credits	Credit Compliance Criteria	Caesarstone Compliance
Indoor Environment Quality	Volatile Organic Compounds	IEQ-12	4	If 100% of the flooring surface used is any Caesarstone engineered stone, these materials will contribute towards the achievement of 1 credit point. Where Caesarstone is used for as table tops for furniture, these materials will contribute towards the achievement of 1 credit point.	Caesarstone stone surfaces have been certified to the Greenguard Children & Schools standard as low emitting products and confirm compliance to Green Star VOC levels of: <b>Total VOC limit:</b> 0.5mg/m2 per hour <b>4-PC:</b> 0.05mg/m2 per hour
Materials	Recycled-Content & Reused Products and Materials	Mat-8	1	Caesarstone Mosaici products have a minimum post consumer recycled content exceeding 20% and will contribute towards this achievement of this credit. <b>Credit Criteria:</b> 1 point is awarded where it is demonstrated that materials selected for building construction representing at least 2% of the project's total contract value have a post consumer recycled content of at least 20% or are reused from the existing or any other building.	Caesarstone declares that the post consumer recycled content of the Mosaici range (7150 & 7250) is a minimum of 30% by mass.
Materials	Flooring	Mat-9	3	If 100% of the flooring surface used is Caesarstone Mosaici range, these materials will contribute 27% of 1 point under the following criteria in the materials Calculator: <b>Eco preferred Content</b> <b>Durability</b> <b>Environmental Management Systems</b>	Caesarstone declares that the post consumer recycled content of the Mosaici range (7150 & 7250) is a minimum of 30% by mass. Caesarstone has a published 10 year limited warranty for all its products. Caesarstone has a current ISO 14001 certificate for its manufacturing plant in Israel.
Materials	Loose Furniture	MAT-10	3	If 100% of the table surface used is Caesarstone Mosaici range, these materials will contribute up to 32% of 1 point under the following criteria in the materials Calculator: <b>Eco preferred Content</b> <b>Durability</b> <b>Environmental Management Systems</b>	Caesarstone declares that the post consumer recycled content of the Mosaici range (7150 & 7250) is a minimum of 30% by mass. Caesarstone has a published 10 year limited warranty for all its products. Caesarstone has a current ISO 14001 certificate for its manufacturing plant in Israel.

## 10. Green Star Compatibility continued

10.2.5 Green Star Healthcare PILOT Tool					
Environmental Impact Category	Credit Title	Credit No	Available Credits	Credit Compliance Criteria	Caesarstone Compliance
Indoor Environment Quality	Volatile Organic Compounds	IEQ-13	4	If 100% of the flooring surface used is any Caesarstone engineered stone, these materials will contribute towards the achievement of 1 credit point.	Caesarstone stone surfaces have been certified to the Greenguard Children & Schools standard as low emitting products and confirm compliance to Green Star VOC levels of: <b>Total VOC limit:</b> 0.5mg/m2 per hour <b>4-PC:</b> 0.05mg/m2 per hour
Materials	Recycled-Content Products and Materials	Mat-4	2	Caesarstone Mosaici products have a minimum post consumer recycled content exceeding 25% and will contribute towards this achievement of this credit. <b>Credit Criteria:</b> Up to two points are awarded where it is demonstrated that materials selected for base building construction have a post-consumer recycled content of at least 25% or a post-industrial content of at least 50%, as follows: 1 point is awarded where recycled materials represent at least 5% of the project's total contract value; and 2 points are awarded where recycled materials represent at least 10% of the project's total contract value.	Caesarstone declares that the post consumer recycled content of the Mosaici range (7150 & 7250) is a minimum of 30% by mass.
	Flooring	Mat-9	3	If 100% of the flooring surface used is Caesarstone Mosaici range, these materials will contribute 27% of 1 point under the following criteria in the materials Calculator: <b>Eco preferred Content</b> <b>Durability</b> <b>Environmental Management Systems</b>	Caesarstone declares that the post consumer recycled content of the Mosaici range (7150 & 7250) is a minimum of 30% by mass. Caesarstone has a published 10 year limited warranty for all its stone products. Caesarstone has a current ISO 14001 certificate for its Stone plant in Israel.
	Joinery	Mat-11	1	If 100% of the countertops used is Caesarstone Mosaici range, these materials will contribute up to 1 point (33% of the product score) under the following criteria in the materials Calculator: <b>Eco preferred Content</b>	Caesarstone declares that the post consumer recycled content of the Mosaici range (7150 & 7250) is a minimum of 30% by mass.
	Loose Furniture	MAF-12	4	If 100% of the table surface used is Caesarstone Mosaici range, these materials will contribute up to 32% of 1 point under the following criteria in the materials Calculator: <b>Eco preferred Content</b> <b>Durability</b> <b>Environmental Management Systems</b>	Caesarstone declares that the post consumer recycled content of the Mosaici range (7150 & 7250) is a minimum of 30% by mass. Caesarstone has a published 10 year limited warranty for all its stone products. Caesarstone has a current ISO 14001 certificate for its Stone plant in Israel.

10.2.6 Green Star Shopping Centre PILOT Tool					
Environmental Impact Category	Credit Title	Credit No	Available Credits	Credit Compliance Criteria	Caesarstone Compliance
Indoor Environment Quality	Volatile Organic Compounds	IEQ-8	3	If 100% of the flooring surface used is any Caesarstone engineered stone, these materials will contribute towards the achievement of 1 credit point.	Caesarstone stone surfaces have been certified to the Greenguard Children & Schools standard as low emitting products and confirm compliance to Green Star VOC levels of: <b>Total VOC limit:</b> 0.5mg/m2 per hour <b>4-PC:</b> 0.05mg/m2 per hour
Materials	Recycled-Content Products and Materials	Mat-9	2	Caesarstone Mosaici products have a minimum post consumer recycled content exceeding 25% and will contribute towards this achievement of this credit. <b>Credit Criteria:</b> Up to two points are awarded where it is demonstrated that materials selected for base building construction have a post-consumer recycled content of at least 25% or a post-industrial content of at least 50%, as follows: 1 point is awarded where recycled materials represent at least 1% of the project's total contract value; and 2 points are awarded where recycled materials represent at least 2% of the project's total contract value.	Caesarstone declares that the post consumer recycled content of the Mosaici range (7150 & 7250) is a minimum of 30% by mass.

10.2.7 Green Star Multi Unit Residential PILOT Tool					
Environmental Impact Category	Credit Title	Credit No	Available Credits	Credit Compliance Criteria	Caesarstone Compliance
Indoor Environment Quality	Volatile Organic Compounds	IEQ-8	3	If 100% of the flooring surface used is any Caesarstone engineered stone, these materials will contribute towards the achievement of 1 credit point.	Caesarstone stone surfaces have been certified to the Greenguard Children & Schools standard as low emitting products and confirm compliance to Green Star VOC levels of: <b>Total VOC limit:</b> 0.5mg/m2 per hour <b>4-PC:</b> 0.05mg/m2 per hour
Materials	Recycled-Content Products and Materials	Mat-7	1	Caesarstone Mosaici products have a minimum post consumer recycled content exceeding 25% and will contribute towards this achievement of this credit. <b>Credit Criteria:</b> 1 point is awarded where it is demonstrated that materials selected for building construction representing at least 1% of the project's total contract value have a post consumer recycled content of at least 20% or are reused from the existing or any other building.	Caesarstone declares that the post consumer recycled content of the Mosaici range (7150 & 7250) is a minimum of 30% by mass.
Materials	Floor Coverings	Mat-9	1	If 100% of the table surface used is Caesarstone Mosaici range, these materials will contribute up to 27% of 1 point under the following criteria in the materials Calculator: <b>Eco preferred Content</b> <b>Durability</b> <b>Environmental Management Systems</b>	Caesarstone declares that the post consumer recycled content of the Mosaici range (7150 & 7250) is a minimum of 30% by mass. Caesarstone has a published 10 year limited warranty for all its stone products. Caesarstone has a current ISO 14001 certificate for its Stone plant in Israel.



# 11. Technical Data

Test Performed	Test Standard	Results	Remarks
<b>PHYSICAL PROPERTIES</b>			
Water Absorption	ASTM C 97 EN14617 1	≤ 0.05%	
Bulk Specific Gravity	ASTM C 97	2.411 gr/cm <sup>3</sup>	
Flexural Strength <sup>1</sup>	ASTM C 880	6,500-10,770 psi	Stronger than most natural stones
Thermal Expansion <sup>1</sup>	ASTM D 696	9.80E-06 in/in/°F	3000 series
<b>DURABILITY</b>			
Abrasion Resistance <sup>1</sup>	ASTM C 501	216-696	Abrasion Wear Index by Taber Abraser
Freeze-Thaw Resistance	ASTM C 1026	No defects	15 freeze-thaw cycles
Mohs Hardness		7	Quartz = 7 on Mohs scale
<b>STAIN AND CHEMICAL RESISTANCE AND CLEANABILITY</b>			
Stain Resistance <sup>1,2</sup>	ANSI Z 124.6	32-48 Pass (maximum pass criterion is 64)	16-hour exposure to: black crayon, black liquid shoe polish, blue washable ink, gentian violet solution, beet juice, grape juice, lipstick, hair dye, iodine solution, and wet tea solution.
Wear and Cleanability	ANSI Z 124.6	Pass	Wear: Passes 10,000 scrub cycles. Cleanability: Loss of light reflectance after 25 cycles is 1%-3% (pass criterion is <5%).
Chemical Resistance	ANSI Z 124.6	Pass	16-hour exposure to: naphtha, ethyl alcohol, amyl acetate, ammonia 10%, citric acid 10%, urea 6%, toluene, ethyl acetate, acetone, vinegar, hydrogen peroxide 3%, lye 1%-2%, sodium hypochlorite, trisodium phosphate 5%, and pine oil.
<b>THERMAL RESISTANCE</b>			

Test Performed	Test Standard	Results	Remarks
Boiling Water Resistance	NEMA LD 3-3.5	Pass – no effect	While short-term contact with hot materials up to temperature tested will not harm quartz surfacing, hot cookware should not be placed directly on the surface; use insulated hot pads or trivets.
High Temperature Resistance	NEMA LD 3-3.6	Pass – no effect	No effect (no change in colour or surface finish) when tested at 356°F (180°C) for 20 minutes
<b>SAFETY</b>			
Cigarette Test	ANSI Z 124.6	No ignition or glow	Resistant to ignition or glow by cigarettes.
Static Coefficient of Friction as received under wet and dry conditions	ASTM C 1028	<u>Dry</u> <u>Wet</u> 0.84    0.51	3000 series
Static Coefficient of Friction as renovated under wet and dry conditions	ASTM C 1028	<u>Dry</u> <u>Wet</u> 0.86    0.55	3000 series
Surface Burning	ASTM E 84	Flame spread = 5 Smoke developed = 25	Class 1 per International Code Council (ICC) and Class A per National Fire Protection Agency (NFPA).
Radiation	ANSI/N42.14 1999	<sup>226</sup> Ra = 1.4-6.8 <sup>232</sup> Th = 1.4-3.7 <sup>40</sup> K = <3-30.3 (Bq/kg dry weight)	The level of radioactivity is relatively low in comparison to similar building materials. Quartz surfacing meets European standards stated in Radiation Protection No. 112 – “Radiological Protection Principles Concerning the Natural Radioactivity of Building Materials”.
<b>CERTIFICATIONS &amp; APPROVALS</b>			
Kosher		Certified by the Zomet Institute, Israel	Slabs are kosher due to low porosity.
GREENGUARD	Certified for “Indoor Air Quality” and “Children and Schools”		Quartz surfacing is a low-emitting material.
New York City Materials and Equipment Acceptance	MEA 202-08-M	Approved by City of New York	
ANSI/NSF Standard 51	Food Equipment Materials	Listed by NSF	Safe to use in food preparation areas.

## 12. Outdoor Collection

### 12.1 Introduction

Caesarstone introduces the Outdoor Collection. For the first time, Caesarstone has combined the best of all it has to offer by taking the luxury of its much-loved surfaces to the outdoors. Its ground-breaking Outdoor Collection provides the convenience of stain-resistant, easy-to-clean surfaces, while innovating a highly durable material proven to withstand UV rays and the most extreme environmental conditions over the long term. The new Outdoor Collection provides an answer for consumers' desire to cook, dine and entertain comfortably in an outdoor kitchen, come rain, snow or shine.

Caesarstone Outdoor performs the same as traditional Caesarstone in most aspects relating to fabrication, installation, repairs, and care & maintenance. Therefore, in most cases, the same procedures, tools and equipment can be used for both products.

There are, however, some minor differences, which are specified in this technical guide. Fabricators and installers should use these guidelines in addition to the Caesarstone *Fabrication & Installation Guide* for optimum work with Caesarstone Outdoor.

**Please note that Caesarstone Outdoor is not suitable for flooring and wall cladding.**

### 12.2 Slab Data

#### 12.2.1 Finishes

Caesarstone Outdoor is available in two finishes: Concrete and Honed.

#### 12.2.2 Dimensions & Weight

Length	3040 mm (120") +/- 10 mm (3/8")	
Width	1440 mm (56 1/2") +/- 10 mm (3/8")	
Thickness	20 mm +/- 1 mm	
Weight	189-210 kg/slab	417-463 lb
	43-48 kg/m <sup>2</sup>	8-10 lb/ft <sup>2</sup>

 **Note:** Imperial measurements in this guide are approximate.

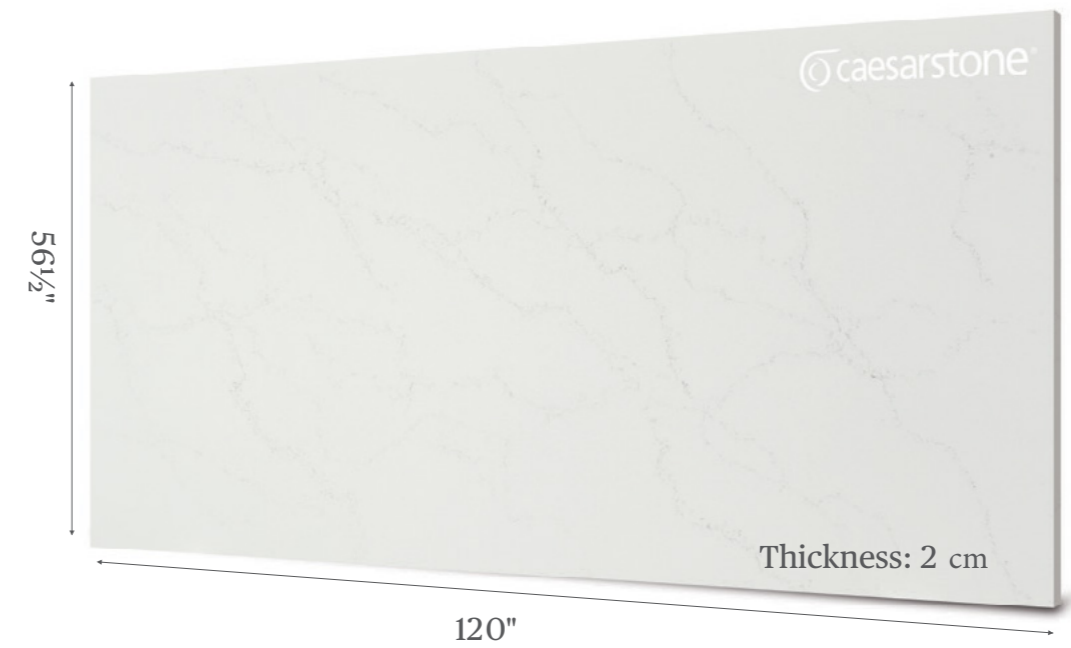

#### 12.2.3 Slab Label

- The Caesarstone Outdoor slab label has a blue border.
- The rest of the slab label is the same as for traditional Caesarstone.



## 12. Outdoor Collection continued

### 12.3 Fabrication Guidelines Specific to Caesarstone Outdoor

Caesarstone Outdoor contains up to 90% crystalline silica. Fabrication of Caesarstone Outdoor generates respirable dust that is dangerous to your health. For more information about this danger and means of protection that you should implement please see the *Caesarstone Good Practice Guide - Steps to Avoid Health Hazards Related to Crystalline Silica Dust* at: [mos.caesarstone.co.uk](https://mos.caesarstone.co.uk).

- Caesarstone Outdoor slabs offer fabricators all the same advantages of easy fabrication as traditional Caesarstone. Due to the different composition, Caesarstone Outdoor slabs give off a smell during fabrication that is different from traditional Caesarstone; and it may be necessary to exert slightly more pressure when working manually.
- When cutting 45° mitre edges, do not exceed a feed rate of 1 m (40") per minute.
- Set the RPM at 1600.

💡 Measuring can also be easily performed by digital templating, which significantly increases the efficiency, accuracy and speed of templating.

Note: Cutout guidelines are the same for Caesarstone Outdoor and indoor Caesarstone:

- The minimum recommended radius for cutout corners is 10 mm (3/8"). The larger the radius, the stronger the corner.
- The minimum recommended distance between a cutout and an edge or seam is 60 mm (2 1/2").



### 12.4 Installation Guidelines Specific to Caesarstone Outdoor

#### 12.4.1 General

- Support Caesarstone Outdoor on a full substrate of concrete, brick or cement board. Do not use wood as it can swell in an outdoor environment.



#### 12.4.2 Grill Installation Guidelines

- The grill should be supported by a concrete or brick structure or a dedicated frame, not by the Caesarstone Outdoor surface.
- Create seams for all inside corners.
- Create 5 mm (3/16") seams that follow the grill edges.
- Provide a minimum gap of 15 mm (5/8") between the grill and the edge of the cutout.
- Do not completely surround the grill with the surface - at least one side must be open.
- Ensure that the grill pane is located above the level of the Caesarstone Outdoor surface.
- If there is a wall behind the grill, the surface depth between the grill and the wall must be at least 130 mm (5").

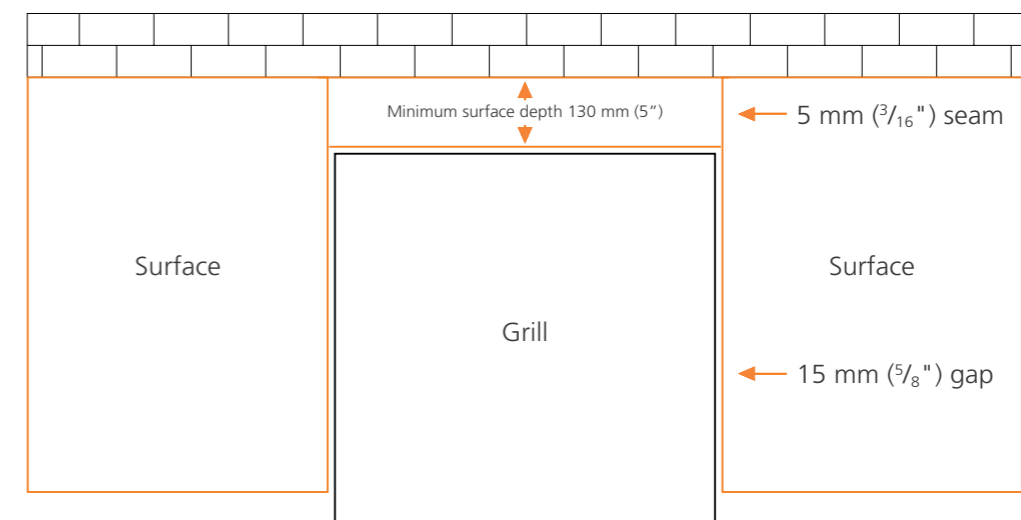

# 13. Residential Lifetime Warranty



## Care & Maintenance

### Taking Care of Your Quartz Surface

Caesarstone quartz surfaces blend modern sophistication and timeless luxury with unbeatable strength and durability. The ever-lasting finish requires only simple and routine care to maintain its good looks. To clean Caesarstone, we recommend using warm water and a mild detergent or quality spray and wipe type cleaner in order to enjoy enduring beauty and unmatched performance for years to come.

### Minimal Maintenance

Virtually maintenance-free, Caesarstone's hard, non-porous surfaces require no sealing to renew the lustre and are simple to clean. In most cases, soap and water or a mild detergent is enough to keep your Caesarstone countertop looking like new. If necessary, use a non-abrasive soft soap along with a non-scratch or delicate scrub pad. Afterwards, thoroughly rinse with clean water to remove residue.

### Stubborn Stains or Dried Spills

If needed, apply a non-abrasive household cleaner (a non-abrasive cleaner will not dull the surface shine) and rinse to remove residue. To remove adhered material such as food, gum, nail polish or even dried paint, first scrape away excess material with a plastic putty knife and then use a damp cloth to remove any marks or residual dirt.

For extra-stubborn stains, a no-scratch Scotch-Brite® pad is recommended along with the non-abrasive cleaner recommended by our local Caesarstone® distributor.

### Heat Tolerance

Caesarstone is more heat resistant than other stone surfaces including most granite, marble and limestone; and is not affected by temperatures lower than 100°C. However, like all stone material, Caesarstone can be damaged by sudden and rapid temperature changes. Therefore, we suggest that hot pots and pans never be directly placed on the surface. We also recommend a hot pad or trivet be placed on the surface under cooking units such as electric frying pans, crock pots, or roaster ovens.

### Scratch Resistant

Caesarstone is a highly scratch resistant surface; however avoid abuse of the surface by refraining from using sharp objects such as sharp knives or screw drivers directly onto the surface.

### Cleaning Agents to Avoid

It's important to be aware that like any other surface, Caesarstone can be permanently damaged if exposed to strong chemicals and solvents that can damage its physical properties. Never clean your Caesarstone surface with products that contain Trichlorethane or Methylene chloride, such as paint removers or strippers. Avoid the use of highly aggressive cleaning agents such as oven/grill cleaners and dishwasher polishing agents that have high alkaline/pH levels (pH 8.5 or higher). Products containing oils or powders may leave a residue and should be rinsed off thoroughly. Should your surface accidentally be exposed to any of these damaging products, rinse immediately with clean water to neutralize the effect.

## Lifetime\* Warranty (Residential)

International Slab Sales (Pty) Ltd. Reg No. 1996/011537/07 ("the Distributor") hereby furnishes a limited warranty ("the Warranty") to any purchaser of Caesarstone products ("the products") that the products will be free from manufacturing defects for a lifetime from the date of installation.

### For the avoidance of doubt:

1. This Warranty is available only to the original owner of the domestic residence ("the residence") in which the Product was originally installed ("Purchaser").
2. In the case of a newly constructed domestic residence, this Warranty is available to the "first" owner who purchased the residence from a builder or developer with the product permanently installed therein.
3. A domestic residence shall relate to any location which is a private residence used for familial habitation and for no commercial purpose whatsoever.

### Terms and Conditions

#### This warranty shall:

1. Only apply to products which were installed in a residence after 1 August 2009
2. Expire upon transfer of ownership of the residence to any third party after a period of a lifetime from date of installation has elapsed, whichever the earlier;
3. Not be valid in instances where the product has not been paid in full; and
4. At all times be subject to the terms and conditions herein contained.

### This Warranty shall apply for interior use and only when the product is:

1. Properly installed;
2. Maintained in accordance with The Guidelines for Care and Maintenance (which are available on request or on line at [www.caesarstone.co.za](http://www.caesarstone.co.za)) and which forms part of this warranty;
3. Used solely for the specific purpose of countertops and/or wall cladding;
4. Permanently installed and has not been moved from the original installation.
5. The Distributor shall only be responsible for proven manufacturing defects in the product which shall be determined by the distributor in its sole and absolute discretion. The Distributor will have the right at all times to examine purportedly defective product and its installation and maintenance. Any remedy against the Distributor shall be, at the Distributor's sole discretion, to either replace the defective product with the equivalent product or refund the purchase price. The warranty is exclusive and in lieu of any other warranty expressed or implied including any implied warranty of merchantability, fitness for purpose, or other warranty of quality, whether expressed or implied, and all other liabilities or obligations on the part of the distributor or Caesarstone. Under no circumstances will the distributor be liable for direct, indirect, general, special, incidental, consequential, or other damages of any kind whatsoever, regardless of the cause of such damage.

### Exclusions:

#### This Warranty does not cover:

1. Any cost or expenses incurred or relating to the removal and/or re installation of the product or replacement of the product and/or transportation costs and/or loss of profit and/or any other related expenses
2. Any instance where the Purchaser is not the occupier of the residence
3. Use of the product for any commercial purposes, Commercial usage includes but is not limited to, use of the Product in high traffic areas such as in a store, rental property, offices or any other places of business
4. Any outdoor application
5. Fireplace or braai surrounds
6. Flooring application
7. Instances where the product is/was used improperly or abused or otherwise has suffered impact damage
8. Scratches
9. Routine maintenance
10. Improper installation
11. Any chemical damage
12. Any creative use of the material including bending or curving
13. Material that has been milled or reduced in thickness
14. The altering of any factory applied finish
15. Natural variations in the colour, size, shape and distribution of the pattern of the natural quartz or the natural variations in background tone
16. Spots or blemishes which are inherent in the manufacturing process and do not affect the structural integrity of the material
17. Instances where the product information on the back of each slab has been removed. Removing this product information will void the warranty.
18. Material that has had a natural deterioration of colour over time, due to normal but extreme environmental conditions.

### PROCEDURAL ASPECTS IN RESPECT OF THE WARRANTY

In order for the warranty to be effectual it is essential that the Purchaser ensures that this Warranty is fully and accurately completed. Prior to doing so it is incumbent on the Purchaser to ensure that he/she/it is satisfied with the Product and the installation thereof. Furthermore it is incumbent on the Purchaser to ensure that the original Residential Warranty headed "LIFETIME LIMITED WARRANTY (RESIDENTIAL)" (which can be downloaded from the website) has been read, understood and accepted and that the completed warranty registration is returned to the Distributor within 28 days of the installation. The completed warranty registration should be returned to the distributor by e-mail to the following address [technical@interslab.co.za](mailto:technical@interslab.co.za) Upon receipt of the warranty registration by the Distributor acknowledgement of the registration will be sent back to the e-mail address from which the registration was sent. This acknowledgement will serve as proof of registration.

This warranty constitutes the entire warranty given to the First owner and supersedes all other warranties and representations, whether oral or written, except as expressly set out above. No person other than the duly authorised representatives of the Distributor is authorised to make any warranty promise or representation on behalf of the Distributor and any such representations must be reduced to writing and signed prior to being effectual.



+27 (0) 83 608 5810  
[caesarstone.co.za](http://caesarstone.co.za)

# 14. Commercial Warranty



## Care & Maintenance

### Taking Care of Your Quartz Surface

Caesarstone quartz surfaces blend modern sophistication and timeless luxury with unbeatable strength and durability. The ever-lasting finish requires only simple and routine care to maintain its good looks. To clean Caesarstone, we recommend using warm water and a mild detergent or quality spray and wipe type cleaner in order to enjoy enduring beauty and unmatched performance for years to come.

### Minimal Maintenance

Virtually maintenance-free, Caesarstone's hard, non-porous surfaces require no sealing to renew the lustre and are simple to clean. In most cases, soap and water or a mild detergent is enough to keep your Caesarstone countertop looking like new. If necessary, use a non-abrasive soft soap along with a non-scratch or delicate scrub pad. Afterwards, thoroughly rinse with clean water to remove residue.

### Stubborn Stains or Dried Spills

If needed, apply a non-abrasive household cleaner (a non-abrasive cleaner will not dull the surface shine) and rinse to remove residue. To remove adhered material such as food, gum, nail polish or even dried paint, first scrape away excess material with a plastic putty knife and then use a damp cloth to remove any marks or residual dirt.

For extra-stubborn stains, a no-scratch Scotch-Brite® pad is recommended along with the non-abrasive cleaner recommended by our local Caesarstone® distributor.

### Heat Tolerance

Caesarstone is more heat resistant than other stone surfaces including most granite, marble and limestone; and is not affected by temperatures lower than 100°C. However, like all stone material, Caesarstone can be damaged by sudden and rapid temperature changes. Therefore, we suggest that hot pots and pans never be directly placed on the surface. We also recommend a hot pad or trivet be placed on the surface under cooking units such as electric frying pans, crock pots, or roaster ovens.

### Scratch Resistant

Caesarstone is a highly scratch resistant surface; however avoid abuse of the surface by refraining from using sharp objects such as sharp knives or screw drivers directly onto the surface.

### Cleaning Agents to Avoid

It's important to be aware that like any other surface, Caesarstone can be permanently damaged if exposed to strong chemicals and solvents that can damage its physical properties. Never clean your Caesarstone surface with products that contain Trichlorethane or Methylene chloride, such as paint removers or strippers. Avoid the use of highly aggressive cleaning agents such as oven/grill cleaners and dishwasher polishing agents that have high alkaline/pH levels (pH 8.5 or higher). Products containing oils or powders may leave a residue and should be rinsed off thoroughly. Should your surface accidentally be exposed to any of these damaging products, rinse immediately with clean water to neutralize the effect.

## Commercial Warranty

International Slab Sales (Pty) Ltd. Reg No. 1996/011537/07 ("the Distributor") hereby furnishes a limited warranty ("the Warranty") to any purchaser of Caesarstone products ("the products") that the products will be free from manufacturing defects for a period of 10 years from the date of installation.

### For the avoidance of doubt:

1. The Warranty is available only to a person (natural or juristic) who was the owner of a Commercial property at the time when the Product was originally installed ("the Purchaser");
2. Commercial property shall relate to any location which is open to the general public for business use, private properties subject to residential or commercial rental or lease, or properties designated as restaurants, hotels, motels or other temporary residence applications.
3. Commercial installations shall relate to all surface installations in a Commercial property.

### Terms and Conditions

#### This warranty shall:

1. Only apply to products which were installed in Commercial Property after 1 August 2009;
2. expire upon transfer of ownership of the structure to any third party or after a period of 10 years from date of installation has elapsed, whichever the earlier;
3. not be valid in instances where the product has not been paid in full; and;
4. at all times be subject to the terms and conditions herein contained.

### This Warranty shall apply for interior use and only when the product is:

1. Properly installed;
2. Maintained in accordance with The Guidelines for Care and Maintenance (which are available on request or on line at [www.caesarstone.co.za](http://www.caesarstone.co.za)) and which forms part of this warranty;
3. Used solely for the specific purpose of countertops and/or wall cladding;
4. Permanently installed and has not been moved from the original installation.
5. The Distributor shall only be responsible for proven manufacturing defects in the product which shall be determined by the distributor in its sole and absolute discretion. The Distributor will have the right at all times to examine purportedly defective product and its installation and maintenance. Any remedy against the Distributor shall be, at the Distributor's sole discretion, to either replace the defective product with the equivalent product or refund the purchase price. The warranty is exclusive and in lieu of any other warranty expressed or implied including any implied warranty of merchantability, fitness for purpose, or other warranty of quality, whether expressed or implied, and all other liabilities or obligations on the part of the distributor or Caesarstone. Under no circumstances will the distributor be liable for direct, indirect, general, special, incidental, consequential, or other damages of any kind whatsoever, regardless of the cause of such damage.

### Exclusions:

#### This Warranty does not cover:

1. Any cost or expenses incurred or relating to the removal and/or re installation of the product or replacement of the product and/or transportation costs and/or loss of profit and/or any other related expenses
2. flooring applications.
3. any outdoor application.
4. instances where the product is/was used improperly or abused or otherwise has suffered impact damage.
5. scratches.
6. routine maintenance.
7. improper installation.

8. any chemical damage.
9. any creative use of the material including bending or curving.
10. material that has been milled or reduced in thickness.
11. the altering of any factory applied finish.
12. natural variations in the colour, size, shape and distribution of the pattern of the natural quartz or the natural variations in background tone.
13. spots or blemishes which are inherent in the manufacturing process and do not affect the structural integrity of the material.
14. instances where the product information on the back of each slab has been removed. Removing this product information will void the warranty.
15. material that has had a natural deterioration of colour over time, due to normal but extreme environmental conditions.

### PROCEDURAL ASPECTS IN RESPECT OF THE WARRANTY

In order for the warranty to be effectual it is essential that the Purchaser ensures that this Warranty is fully and accurately completed by the Purchaser. Prior to doing so it is incumbent on the Purchaser to ensure he/she/it is satisfied with the Product and the installation thereof. Furthermore it is incumbent on the Purchaser to ensure that the original Warranty headed - "10 YEAR LIMITED WARRANTY (COMMERCIAL)", (which can be downloaded from the website) has been read, understood and accepted, and that the completed warranty registration is returned to the Distributor within 28 days of the installation. The completed warranty registration should be returned to the distributor by e mail to the following address [technical@interslab.co.za](mailto:technical@interslab.co.za). Upon receipt of the warranty registration by the Distributor, acknowledgement of the registration will be sent back to the email address from which the registration was sent. This acknowledgement will serve as proof of registration.

### In order to activate the warranty, all fields must be completed:

Purchasers Name: \_\_\_\_\_  
 Address where installed: \_\_\_\_\_  
 Entity Registration No.: \_\_\_\_\_  
(in the event of a sole propriety of partnership the identity number/s of the proprietor/partners is required)  
 Date of installation: \_\_\_\_\_  
 Caesarstone Fabricator: \_\_\_\_\_  
 Colour: \_\_\_\_\_  
 BatchNo.: \_\_\_\_\_  
(The batch number can be found printed on the underside of the slab and is the number that follows the date in the configuration)

This Warranty contained herein constitutes the entire warranty given to the Purchaser and supersedes all other warranties and representations, whether oral or written, except as expressly set out above. No person other than the duly authorised representatives of the Distributor is authorized to make any warranty, promise or representation on behalf of the Distributor and any such representations must be reduced to writing and signed prior to being effectual.

+27 (0) 83 608 5810 [www.caesarstone.co.za](http://www.caesarstone.co.za)

# 15. The Outdoor Collection Warranty



## Care & Maintenance

### Taking Care of Your Quartz Surface

Caesarstone quartz surfaces blend modern sophistication and timeless luxury with unbeatable strength and durability. The quartz finish requires only simple and routine care to maintain its good looks. To clean Caesarstone, we recommend using warm water and a mild detergent or quality spray and wipe type cleaner in order to enjoy enduring beauty and unmatched performance for years to come. As per the technical manual, the Caesarstone Outdoor Collection should be covered when not in use to ensure longevity and durability.

### Minimal Maintenance

Virtually maintenance-free, Caesarstone's hard, non-porous surfaces require no sealing to renew the lustre and is simple to clean. In most cases, soap and water or a mild detergent is enough to keep your Caesarstone countertop looking like new. If necessary, use a non-abrasive soft soap along with a non-scratch or delicate scrub pad. Afterwards, thoroughly rinse with clean water to remove residue.

### Stubborn Stains or Dried Spills

If needed, apply a non-abrasive household cleaner (a non-abrasive cleaner will not dull the surface shine) and rinse to remove residue. To remove adhered material such as food, gum, nail polish or even dried paint, first scrape away excess material with a plastic putty knife and then use a damp cloth to remove any marks or residual dirt.

For extra-stubborn stains, a no-scratch Scotch-Brite® pad is recommended along with the non-abrasive cleaner recommended by our local Caesarstone® distributor.

### Heat Tolerance

Caesarstone is more heat resistant than other stone surfaces including most granite, marble, and limestone, and is not affected by temperatures lower than 100°C. However, like all stone material, Caesarstone can be damaged by sudden and rapid temperature changes. Therefore, we suggest that hot pots and pans never be directly placed on the surface. We also recommend a hot pad or trivet be placed on the surface under cooking units such as electric frying pans, crock pots, or roaster ovens.

### Scratch Resistant

Caesarstone is a highly scratch resistant surface; however, avoid abuse of the surface by refraining from using sharp objects such as sharp knives or screw drivers directly onto the surface.

### Cleaning Agents to Avoid

It's important to be aware that like any other surface, Caesarstone can be permanently damaged if exposed to strong chemicals and solvents that can damage its physical properties. Never clean your Caesarstone surface with products that contain Trichlorethane or Methylene chloride, such as paint removers and thinners. Caesarstone outdoor surfaces that have been cleaned or exposed to Acetone, Methylates Spirits or Lacquer thinners will automatically be void of warranty. Alcohol may only be used briefly as a cleaning agent by a professional installer during installation. Avoid the use of highly aggressive cleaning agents such as oven/grill cleaners and dishwasher polishing agents that have high alkaline/ pH levels (pH 8.5 or higher). Products containing oils or powders may leave a residue and should be rinsed off thoroughly. Should your surface accidentally be exposed to any of these damaging products, rinse immediately with clean water to neutralize the effect.

## 5-year Limited Warranty (Outdoor Residential)

International Slab Sales (Pty) Ltd. Reg No. 1996/011537/07 ("the Distributor") hereby furnishes a 5-year limited residential warranty ("the Warranty") to any purchaser of installed Caesarstone Outdoor Range Quartz Slabs ("the products"), subject to the terms and conditions set out below.

This warranty applies only to Caesarstone Outdoor surfaces and does not apply to any other products, including other quartz surfacing products manufactured or supplied by any other party. To request service under this warranty you must contact the company that sold you Caesarstone or visit the Caesarstone website ([www.caesarstone.co.za](http://www.caesarstone.co.za)) to contact us directly within twenty-eight (28) days of the failure of Caesarstone Outdoor surfaces.

Following installation, you must register your product to activate your warranty. Simply complete the online form at <https://www.caesarstone.co.za/warranty/register-warranty/>. Laws and building safety regulations governing the design, engineering, and construction of installations vary widely. Caesarstone assumes no responsibility or obligation with respect to the selection of products for the installation or the design, engineering, and construction of the installation.

### For the avoidance of doubt:

1. This Warranty is available only to the original owner of the domestic residence ("a/the residence") in which the Product was originally installed ("Purchaser").
2. In the case of a newly constructed domestic residence, this Warranty is available to the "first" owner who purchased the residence from a builder or developer with the product permanently installed therein.
3. A domestic residence shall relate to any location which is a private residence used for familial habitation and for no commercial purpose whatsoever.
4. Subject to the terms and conditions herein, Caesarstone guarantees You, that the Product will, in all material respects, remain free from defects arising from the manufacture of the Product, for a period of 5 years from the date of installation.

### Terms and Conditions

#### This warranty shall:

1. Apply from the date of installation (subject to You registering the Warranty as per below). This Warranty applies only to Caesarstone Products supplied by Caesarstone SA, and installed within South Africa, which contain Product information on the back and were installed by a qualified and certified fabricator of Caesarstone and paid in full.
2. Expire upon transfer of ownership of the residence to any third party after a period of five years from date of installation has elapsed, whichever the earlier.
3. At all times be subject to the terms and conditions herein contained.

#### This Warranty shall apply for exterior use and only when the product is:

1. Properly and permanently installed and has not been moved from the original installation.
2. Maintained in accordance with The Guidelines for Care and Maintenance (which are available on request or online at [www.caesarstone.co.za](http://www.caesarstone.co.za)) and which forms part of this warranty.
3. In the event that Caesarstone Outdoor surfaces fail due to a manufacturing defect, Caesarstone will, at its sole discretion, repair or replace such materials. Caesarstone will seek to obtain the best possible result, whether we decide to repair or replace your installation. Replacement does not guarantee an exact colour match. All decisions regarding this warranty are at the sole discretion of Caesarstone. No representative, dealer, salesperson, distributor, fabricator, or any other person is authorised to make any warranty or promises on behalf of Caesarstone with respect to Caesarstone quartz surfacing products. If during or after installation you decide you want a different colour or finish, this decision is not covered under warranty.

### This warranty excludes/does not cover:

#### Applications:

1. Use of the product for any commercial purposes, Commercial usage includes but is not limited to, use of the Product in high traffic areas such as in a store, rental property, offices or any other places of business.
2. Products used as flooring and cladding material. This includes any defect in, or damage to, the Product that results from it being used for flooring, swimming pools, or any other application involving exposure of the slab to chemicals, flames, or excessive heat (including fireplaces or braai surrounds).
3. Any defect in, or damage to, the Product which results from not being cleaned or maintained strictly in accordance with the Caesarstone online Care & Maintenance Guide; and minor conditions such as stains and water spots that may be corrected by following the techniques specified in the Guide. Please refer to the full Caesarstone Care & Maintenance recommendations at [www.caesarstone.co.za](http://www.caesarstone.co.za).
4. Damage caused in whole or in part by natural disasters, fire, site conditions, fault of architectural/engineering design, structural movement, acts of vandalism, or accidents.
5. Instances where the product is/was used improperly or abused or otherwise has suffered impact damage.
6. Scratches, routine maintenance, or improper installation.
7. Any defect in, or damage to, the Product that results from: mishandling or misuse of the Product (including without limitation using the Product for purposes other than its intended purposes); placing hot items including, but not limited to hot pans, electric frying pans or oven trays directly on the slab; using materials on the Products which contain Acetone, Trichlorethane or methylene chloride or cleaning agents which have high alkaline/pH levels.
8. Marks such as metal marks, fingerprints, or other signs of daily living. This includes, but is not limited to, marks that are common to finishes other than Polished finishes. Finishes other than Polished, such as Honed, Concrete, Natural and Rough Concrete, are more susceptible to showing everyday marks and spills, and therefore may require more routine cleaning.
9. Natural variations in the colour, size, shape, and distribution of the pattern of the natural quartz or the natural variations in background tone.
10. Spots or blemishes which are inherent in the manufacturing process and do not affect the structural integrity of the material.
11. Any instance where the Purchaser is not the occupier of the residence.
12. Any changes requested by You to change the colour and finish of the Product, or seam appearance or seam performance, adhesives, caulk, or other installation materials.



### Surfaces/Finishes:

1. Any chemical damage or creative use of the material including bending or curving.
2. Additional cost to remove, fabricate and/or reinstall Caesarstone, labour, or other similar activities necessary to complete the replacement or removal of the defective material.
3. Fabrication of the Product, workmanship and any defect or damage resulted thereof or any defect in, or damage to the Product arising from any work done by any person other than Caesarstone.
4. Defects in the installed Product that were visible by the fabricator at the time of fabrication and/or installation. Fabricators are required to perform a visual inspection of all materials prior to fabrication and again prior to installation.
5. Cracks in the Product, including cracks emanating from a sink cut-out, hob cut-out or "L" shaped cut-out, are not a manufacturing defect and therefore not covered under this Warranty. Please note that cracking is usually the result of externally induced mechanical stress on the material after installation. The most likely causes are settlement or movement, heat, or excessive weight being placed on the tops, such as standing or sitting on them.
6. Material that has been milled or reduced in thickness.
7. Damage caused by securing mechanical fasteners directly into the Product.
8. Failures due to inadequate support for the installation, including overhangs in excess of the recommendations provided by Caesarstone.
9. Chipping is not a material fault; it is normally the direct result of an impact to the edge of the countertop surface; as such it is not covered by this Warranty.
10. Mitered edges where the joint is not cut correctly.
11. The altering of any of Caesarstone's factory-applied finishes: Only colours listed as available in the Caesarstone brochure, sample book or website as "honed" are eligible as "honed" finishing, are covered under this Warranty. Any issues arising from "in-shop" honing are the sole responsibility of the fabricator.
12. Costs relating to additional modifications such as plumbing, electrical, tile, cabinets, flooring, etc., that may be necessary to repair or replace the Caesarstone product.
13. Instances where the product information on the back of each slab has been removed. Removing this product information will void the warranty.
14. Damage caused by appliances or additional products brought into contact with Caesarstone products; and damage caused by installation of ancillary products such as sinks, sink brackets, cabinets, water bars, cooktops, and dishwashers.
15. Caesarstone will not cover any damages, costs, or expenses caused to appliances or additional products brought into contact with Caesarstone products and/or any ancillary products as a result of installing, amending, or replacing Caesarstone products.
16. Caesarstone is not responsible for damage or injury caused in whole or in part by natural disasters (such as extreme weather conditions, earthquake, etc.), job site conditions, architectural/engineering design, structural movement, acts of vandalism or accidents and/or damages that were caused by storing and/or loading and/or shipping Caesarstone products in an unreasonable manner and/or not according to Caesarstone's recommendations.
17. Caesarstone shall not be responsible in either contract or tort for any loss of direct, indirect, consequential, incidental, special, exemplary, or punitive damages arising out of the use or the inability to use the products covered by this warranty.
18. Material that has had a natural deterioration of colour over time, due to normal but extreme environmental conditions.
19. Given that Caesarstone slabs are manufactured from natural materials, each slab is unique and variations to shading, quartz distribution and reflectivity do occur and are naturally occurring characteristics of the material. Consequently, (a) the Product supplied to You may be different from marketing samples, which are indicative only; and (b) there can be variations in appearance dependent on artificial or natural lighting. Therefore, such differences and variations are not considered to be manufacturing defects and are not covered by this Warranty.

### How do I Receive Service Under this Warranty?

1. In order to receive service under this Warranty You must provide proof of purchase in the form of a copy of your original receipt or invoice, showing the name of the owner of the residence and the name of the fabricator/installer.
2. To request service under this Warranty You must notify Caesarstone, through the company who sold You the Product or directly to Caesarstone at: +27 (0) 83 608 5810 or [caesarstone@interslab.co.za](mailto:caesarstone@interslab.co.za), as soon as reasonably possible of discovering the manufacturing defect.
3. Upon receipt of your Warranty claim, Caesarstone will fully honour this Warranty subject to the terms and conditions set forth herein.
4. You will be required to cooperate with Caesarstone or its authorised agents in the inspection of the Product and assist us in efforts to perform our obligations under this Warranty.
5. All decisions regarding this Warranty are at the sole discretion of Caesarstone and shall be final and binding on all parties. No representative, dealer, salesperson, distributor, fabricator, installer, or any other person is authorized to make any Warranty or promises on behalf of Caesarstone with respect to Caesarstone Products.

### Caesarstone's Liability Under this Warranty:

1. In any event, Caesarstone's total liability under this Warranty is limited to the purchase price of the Product. Without prejudice to the above, Caesarstone reserves its right to only pay for any relative transportation, fabrication, or installation costs or any other associated charges for tradespersons, costs of removal, or replacement of the existing Product (including without limitation any costs related to plumbing, electricals, or other similar activities necessary to complete the replacement or removal of the defective Product or any damage caused as a result thereof to tiling, cabinets, flooring, etc.) whereafter a full investigation it determines it would be appropriate and reasonable to do so.
2. Caesarstone will not be liable under this contract for any loss or damage as a result of your inability to use the Product where (i) there is no breach of a legal duty of care owed to You by us or by any of our employees or agents; or (ii) such loss or damage is not a reasonably foreseeable result of our breach of this Warranty. Loss or damage is foreseeable if either it is obvious that it will happen or if, at the time the contract was made, both we and You knew it might happen, for example, if You discussed it with us during the sales process.
3. Laws and building safety codes governing the design, engineering, and construction of installations vary widely. Caesarstone assumes no responsibility or obligations with respect to the selection of Products and/or their fitness for the installation or the design, engineering, and construction of the installation.

+27 (0) 83 608 5810 [www.caesarstone.co.za](http://www.caesarstone.co.za)

### Miscellaneous:

This Warranty, and any dispute or claim (including non-contractual disputes or claims) arising out of or in connection with it or its subject matter or formation, shall be governed and construed in accordance with the laws of South Africa. Each party irrevocably agrees that the courts of South Africa shall have exclusive jurisdiction to settle any dispute or claim (including non-contractual disputes or claims) arising out of or in connection with this Warranty or its subject matter or formation.

### PROCEDURAL ASPECTS IN RESPECT OF THE WARRANTY

In order for the warranty to be effectual it is essential that the Purchaser ensures the original Residential Warranty headed "5-YEAR LIMITED WARRANTY (OUTDOOR RESIDENTIAL)" (which can be downloaded from the website) has been read and understood. The warranty registration form needs to be fully and accurately completed online at [www.caesarstone.co.za](http://www.caesarstone.co.za). The distributor will acknowledge receipt of accurately completed warranties via email. This acknowledgement will serve as proof of registration. Prior to registration it is incumbent on the Purchaser to ensure that he/she/it is satisfied with the Product and the installation thereof.

### PLEASE NOTE

1. Caesarstone's Outdoor Range (Collection) is not suitable for walls and flooring.
2. Due to UV Radiation, a colour change of up to 4 delta E units may occur in a period of five years of external use.

This warranty constitutes the entire warranty given to the First owner and supersedes all other warranties and representations, whether oral or written, except as expressly set out above. No person other than the duly authorised representative of the Distributor is authorised to make any warranty promise or representation on behalf of the Distributor and any such representations must be reduced to writing and signed prior to being effectual.



# Contact details

Distributed by:  
**INTERSLAB** EST. 2000

For more information contact us on:

083 608 5810 or [caesarstone@interslab.co.za](mailto:caesarstone@interslab.co.za)

JOHANNESBURG (HEAD OFFICE)  
69 Serenade Road, Elandsfontein,  
Johannesburg, 1401  
P.O Box 14336, Witfield, 1467  
Tel: +27 11 822 1350 | Fax: +27 11 822 1701  
[headoffice@interslab.co.za](mailto:headoffice@interslab.co.za) (sales)

JOHANNESBURG (BRANCH)  
69 Serenade Road, Elandsfontein,  
Johannesburg, 1401  
Tel: +27 11 966 7999  
[issjhb@interslab.co.za](mailto:issjhb@interslab.co.za)

PRETORIA  
176 Vonkprop Street,  
Samcor Park Ext 1, Pretoria, 0184  
Tel: +27 12 803 5671  
[isspta@interslab.co.za](mailto:isspta@interslab.co.za)

MBOMBELA (NELSPRUIT)  
1b Riana Street, Rocky's Drift,  
Mbombela, 1240  
Tel: +27 13 752 8325

DURBAN (KWA-ZULU NATAL)  
133 Rochdale Road,  
Springfield Park, Durban, 4051  
Tel: +27 31 577 2828  
[issdbn@interslab.co.za](mailto:issdbn@interslab.co.za)

CAPE TOWN (WESTERN CAPE)  
10 Gold Street, Northgate Estate,  
Brooklyn, Cape Town, 7405  
Tel: +27 21 511 2353  
[issctn@interslab.co.za](mailto:issctn@interslab.co.za)

GEORGE (GARDEN ROUTE)  
1 Ossie Urban Road, Unit 6,  
George Industria, 6536  
Tel: +27 44 871 1099  
[issgrg@interslab.co.za](mailto:issgrg@interslab.co.za)

GQEBERHA (PORT ELIZABETH)  
33 Leadwood Crescent  
(Off upper Willow Road),  
Fairview, Gqeberha, 6070  
Tel: +27 41 367 5571

LUSAKA (ZAMBIA)  
Unit L, Mungwi Centre, 7403  
Mungwi Road, Lusaka, Zambia  
Tel: +260 770 361 537 or  
+260 960 637 120  
[isszambia@interslab.co.za](mailto:isszambia@interslab.co.za)

MOZAMBIQUE  
Estrada Nacional N°4, 1117,  
Entrance N° 238, City of Matola  
Tel: +258 870 283 454 or  
+258 870 325 807  
[kevin@interslab.co.zm](mailto:kevin@interslab.co.zm)

SLAB SALES AFRICA  
(OFFICIAL DISTRIBUTOR  
IN HARARE, ZIMBABWE)  
Cnr Loreley Close and  
Loreley Crescent, Msasa, Harare  
Tel: 024 244 6226 or 024 244 6227  
[damien@slabsalesafrica.com](mailto:damien@slabsalesafrica.com)